

# **Standard specifications**

## **PST250-H1**

1st Edition: May 25, 2018

KAWASAKI HEAVY INDUSTRIES, LTD.

ROBOT DIVISION

DESIGNED AND MANUFACTURED BY ASTOR LTD.

## 1. Specification of positioner

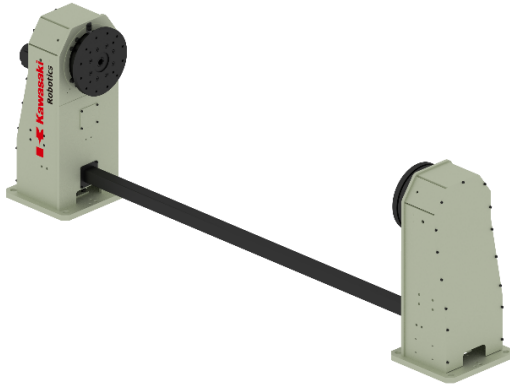

- General purpose single axis positioner,
- Horizontal rotating axis,
- Used as an external axis with Kawasaki robots (E0x controller),
- Based on Kawasaki components and according to Kawasaki standards,
- Simple/modular body design,
- Hollow shaft – for a direct supply of energy and fluids,
- Lightweight.

## 2. Technical parameters

| Model                                  | PST250-H1                           |
|--|-------------------------------------|
| Max. payload                           | 250 kg                              |
| Degree of freedom                      | 1 axis                              |
| Nominal torque                         | 265 Nm                              |
| Max. torque                            | 660 Nm                              |
| Max. tilting torque                    | 850 Nm                              |
| Turning range                          | +/-360°*                            |
| Max. rotating speed                    | 180°/s                              |
| Repeatability                          | ±0.05 mm**                          |
| Max. offset COG from rotating axis JT1 | 105 mm                              |
| Max. mass moment of inertia            | 80 kgm <sup>2</sup>                 |
| Mass                                   | 150 kg                              |
| Default height of rotating axis        | 545 mm                              |
| Installation                           | Floor                               |
| Color                                  | NCS S 0510-G50Y & RAL9011           |
| Built-in utilities                     | Welding ground transfer system      |
| Nominal weld current – 100% duty cycle | 500 A                               |
| Environment cond.                      | 0÷40°C<br>(Humidity) 35÷85%, no dew |

\*possibility of setup range +/-36000

\*\*on radius r=340mm from rotating axis

### 3. Dimensions

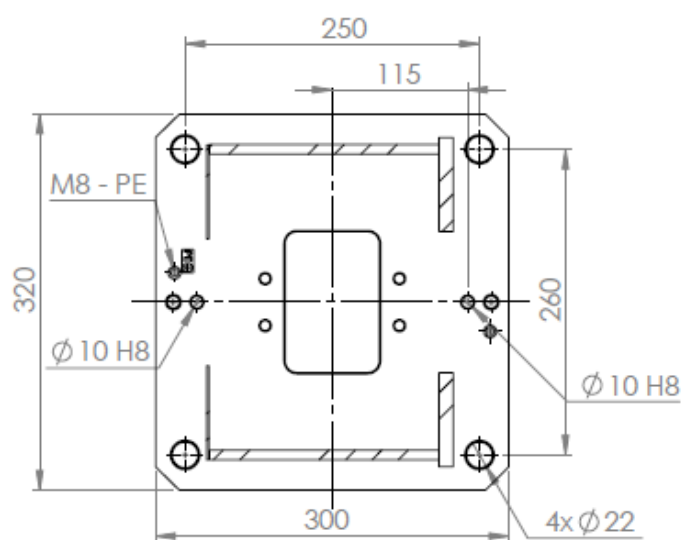
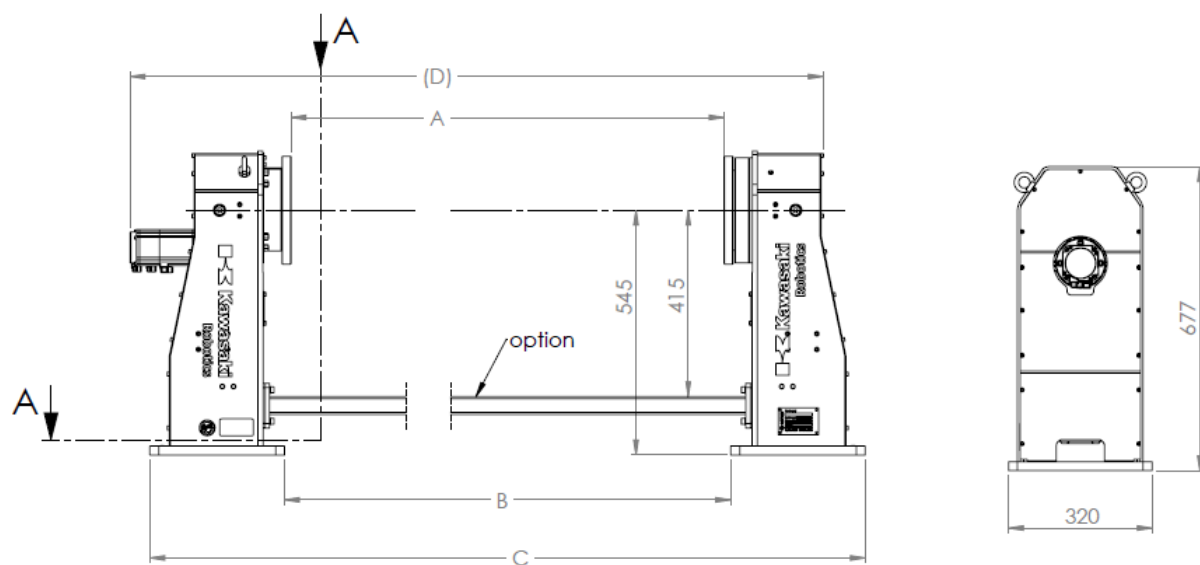

| Dimension | A    | B    | C | D |
|-----------|------|------|---|---|
| 1000      | 1030 | 1630 |   |   |
| 1500      | 1530 | 2130 |   |   |
| 2000      | 2030 | 2630 |   |   |
| 3000      | 3030 | 3630 |   |   |
| 4000      | 4030 | 4630 |   |   |

**A-A**  
**1:5**

The backing plate of the two bases is symmetrical.

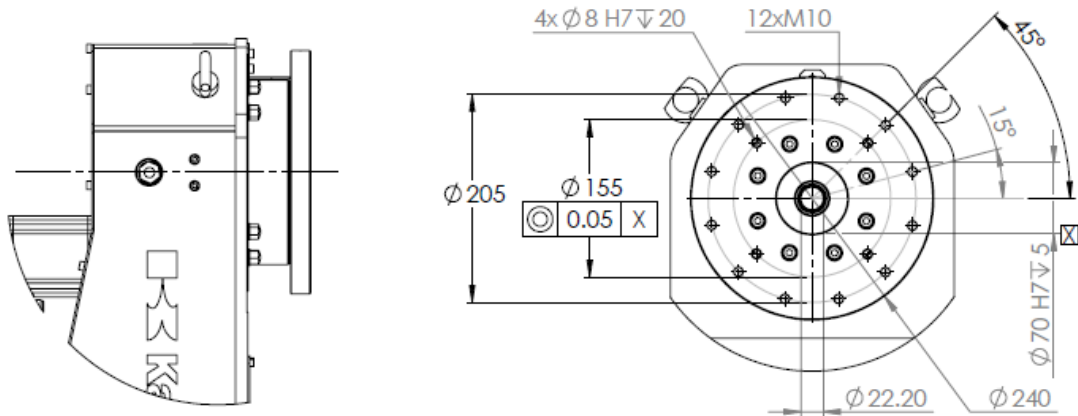

Flange motor

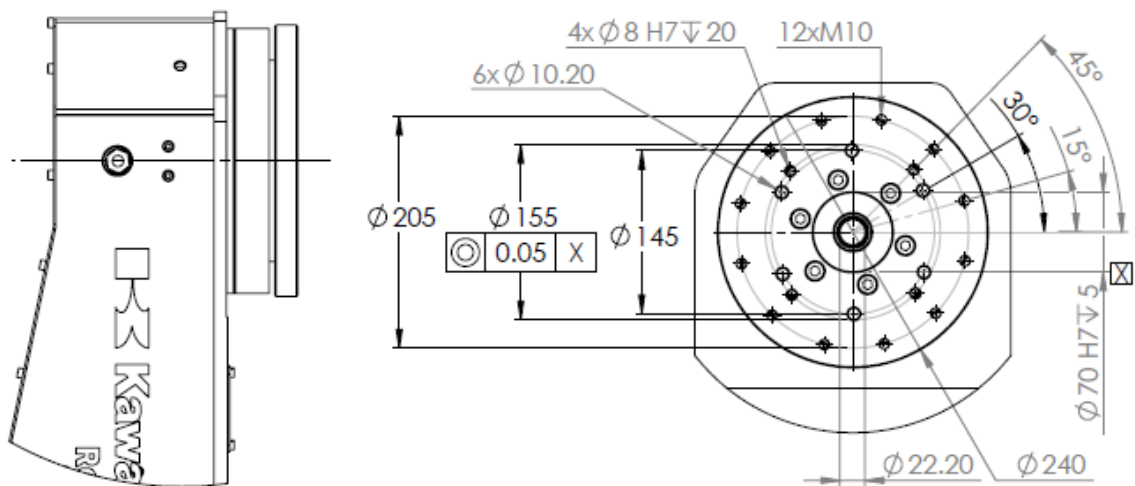

Flange support